

FITTING REPLACEMENT HEADLIGHT INSERTS TO AU XR6 & XR8

Each Twinlight headlamp comes with the following parts

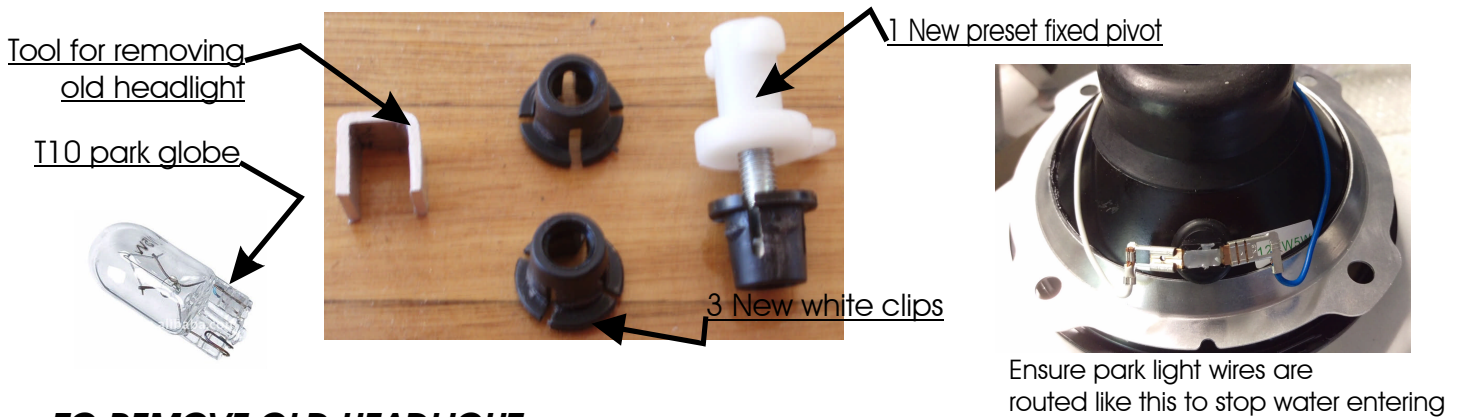

TO REMOVE OLD HEADLIGHT

#1 - Remove headlight assembly

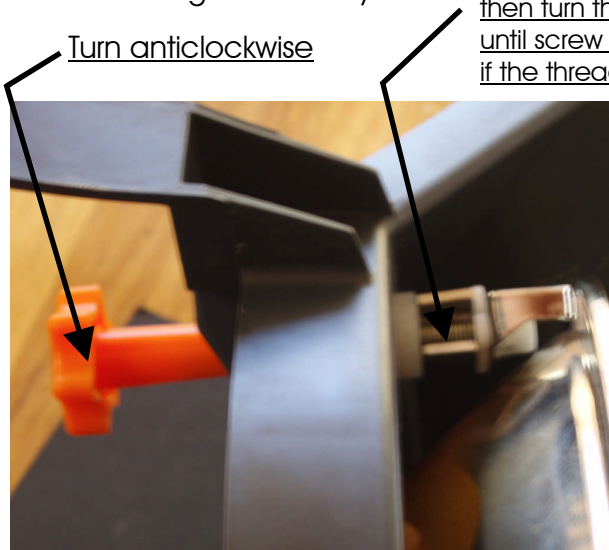

#2 - Place removal tool over adjusting screw then turn the orange adjusting knob anti clockwise until screw pops out of the white ball joint clip on the headlight if the thread strips, butcher the white ball joint clip to remove

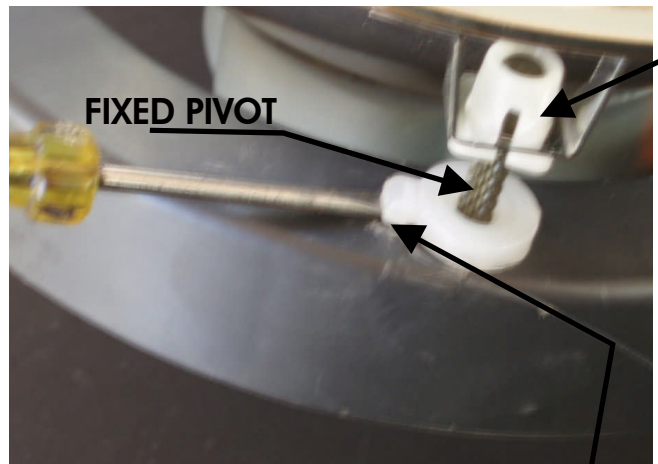

#3 - Force a small screw driver under this lug and lever it up, then rotate the white clip 90 degrees. The clip can now be removed

TO FIT THE NEW HEADLIGHT

#1 - Fit 2 new white clips

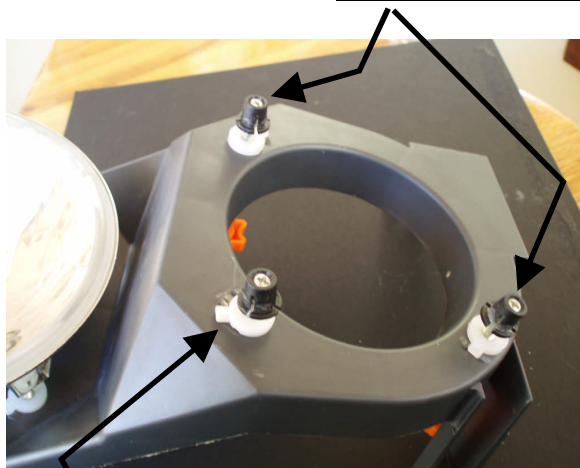

#2 - Fit new preset fixed pivot and rotate until it locks into place

#3 - Place the new headlight onto the 3 black clips ensuring the headlight is rotated to the correct position



#4 - Use long nosed pliers to press the white clips into the aluminum plate

#5 - Reconnect wires as removed